

Standard / Ottomans / Sleepers

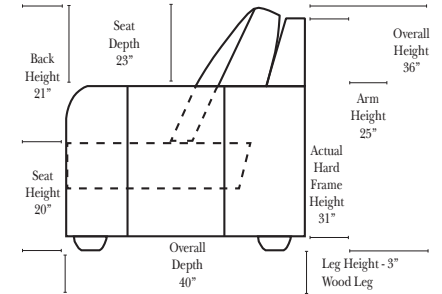
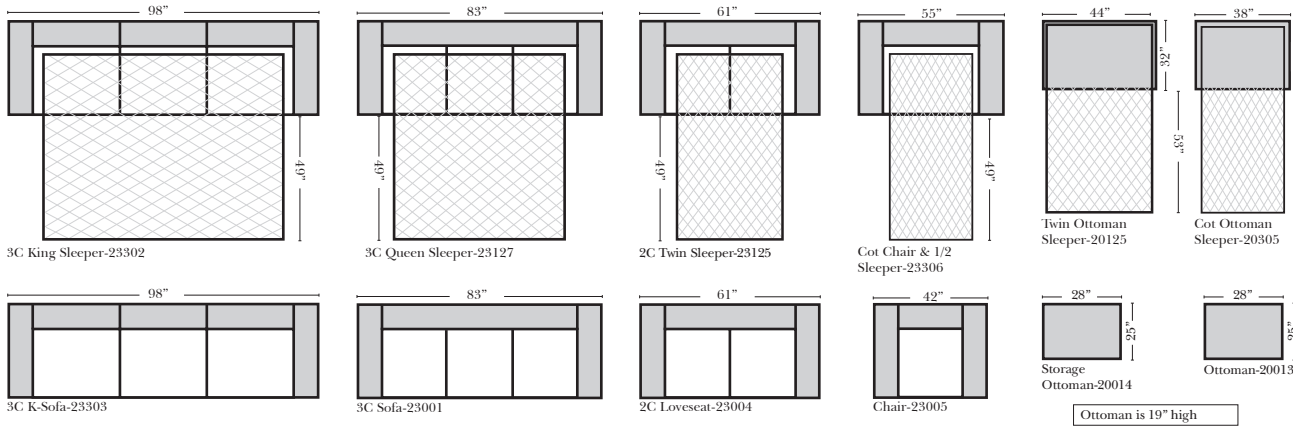

Specifications & Options

Standard:

- Available in Full & Top Grain Leathers
- Available in Luxury Fabrics
- All Hardwood Frames
- Sleeper version (Seat Cushion & Mattress Comprised of High Resiliency Foam with Memory Gel Foam Topper)
- Backs comprised of High Resiliency Foam
- Nail Heads
- Leg Color - Walnut

Options Available with No Additional Charge:

- Change Leg Color to: Cherry, Chocolate, Espresso, Honey Oak, & Shadow
- No. 33 Firm Foam

Options that have Additional Charges: N/A

Sleeper Options : Additional Charges apply

- King Size
- Queen Size
- Twin Size
- Cot Size

Mattress Dimensions - in Inches

- King Size - W 76 x H 4 x L 80
- Queen Size - W 60 x H 4 x L 80
- Twin Size - W 39 x H 4 x L 80
- Cot Size - W 33 x H 4 x L 80

90 Degree / L-Shape Sectional / Sleepers

Put Green Arrows with Red Arrows to Create Sectional Groups

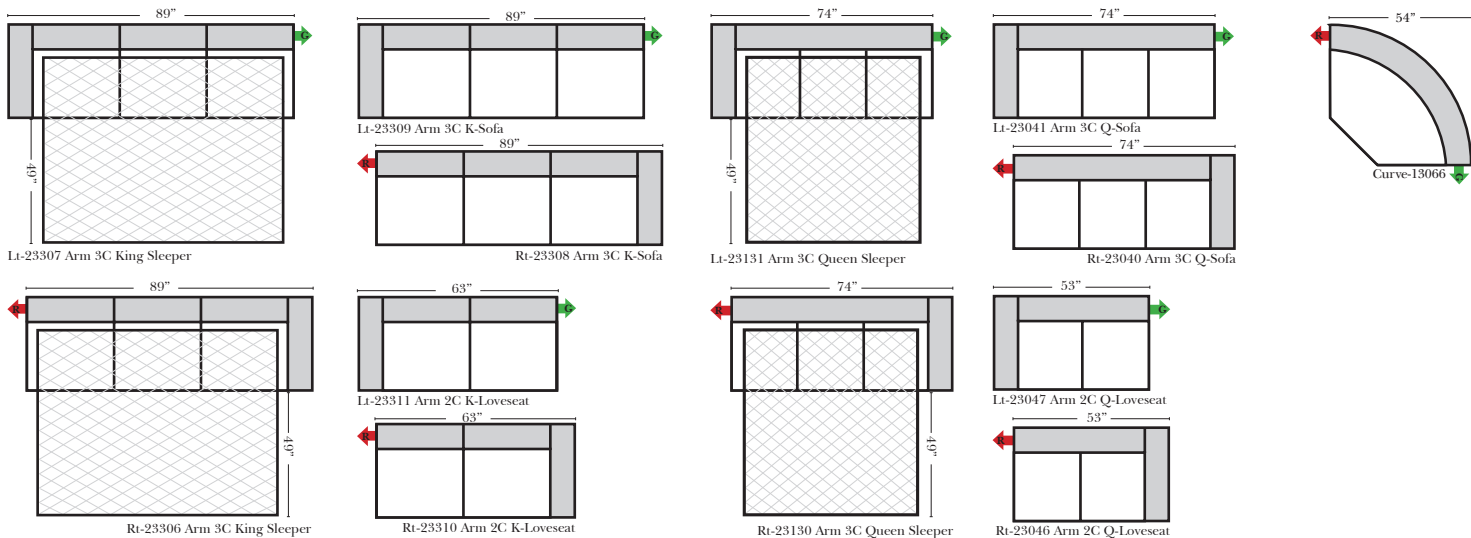

DreamSations[®] Sleeper Attributes:

- Easy to open with fold out legs
- No pillows or seat cushions to remove
- 80" in length comfortable for tall users
- High resiliency foam on seats & backs
- Memory gel foam topper on mattress
- No irritating metal bars or wood slats to feel through mattress

Ready for use in just 2 steps

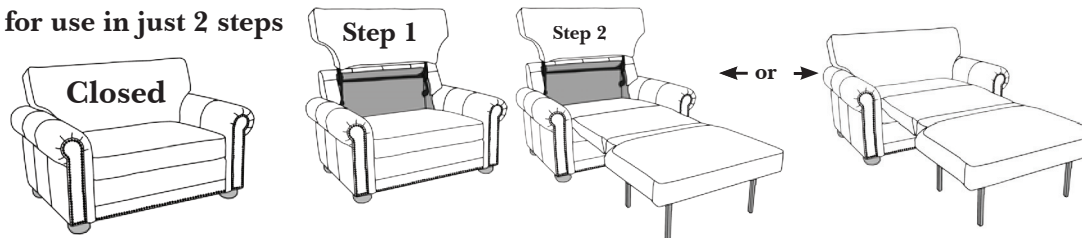

Note:

All Dimensions are approximate, if accuracy is crucial, please contact us for validation of the dimensions shown. However, a 1" to 2" variance can still apply due to foam and upholstery.